

ELF

Fitted Bedroom Kits[©]



ELF Bedrooms



- In Kits!

Catalogue

ELF Miniatures
101 Glenville Grove, London SE 8 4BJ. Tel ++44 (0)20 8694 0536
www.elfminiatures.co.uk

ELF Bedroom Kits[©]

Welcome to the world of ELF Kits[®]!

Following the success of our ELF Kitchen Kits[®], we introduce a new range of bedroom kits. These will enable you to create a truly beautiful contemporary bedroom for your dollshouse in the style and finish that YOU choose at a fraction of the cost of a ready-built one.

ELF Fitted Bedroom Kits[©]

The units are available in various sizes and with doors in several different styles, so that you can create a bedroom that reflects your taste (or that of the occupants of your house!).

Firstly measure your room as accurately as you can, preferably in inches, to the nearest 1/16". Decide whether you wish the units to go from wall-to-wall to create a fully fitted look, but remember that you should allow a little room for fitting, so if your room is 11 inches wide, choose units to a width of 10 1/2". (The minimum gap you should allow is 1/8") You can order a filling strip or strips for the gap/s, which will create a fully fitted look.

If you want to put spanning units over a bed, you should allow two 3" units to span a double bed – this will allow space either side of the bed. If you need a wider gap, then add an additional narrow spanning unit.

If your units are going down one side of the room, ending at the front of the house, or by a door in one wall, allow half an inch space at the end of the run to allow for architrave and side décor panelling.

All the units are 1 7/8" deep, with the exception of the corner unit, which is normally 2" deep in the corner, but may be adapted to conform to the 1 7/8" standard. This is of importance in designing arrangements including a corner unit (see below). Architrave and trim is added at the end, so if your run of units ends near a door or window, you should allow 2 1/8" clearance to allow for this.

Wardrobes are a maximum of 8 3/8" tall (including plinth and architrave). Chests of drawers are 2 11/16" high.

The following designs will explain some of these considerations.



The room on the left is 10 ½" wide, and the units are two 2" single wardrobes (A and D) combined with two 3" double spanning units (Band C) totalling 10". The units have been placed centrally and a filler strip placed either side. The architrave has been cut to fit the entire length, thus creating a fully fitted look. When ordering this bedroom, you would need to order architrave 12" long (which will be trimmed to fit) and plinth 12" (2" for each wardrobe, and 3" for each exposed side, of which there are two – those enclosing the space for the bed). Plinth is supplied in multiples of 6" up to a maximum of 18" in one piece; therefore round up to the nearest amount.

The middle room is 12" wide. The units comprise a corner unit (B), which is 3½" wide (with a 1½" door), two spanning units (C and D), and a further 2" wardrobe (E), thus making a total width of 11½". There is also another 3" wardrobe (A) on the left hand wall, completing the layout. The space between the corner and the door is 5½", leaving enough space to allow for architrave on the units, which are 5" in total along that wall. As this design includes a corner, the excess space is confined to the right, where a filler panel will again give a fully fitted look. This room would also require one 18" architrave section (the top edge measures 13" but it is necessary to add 3" for the exposed end (to allow for mitring), and one 18" plinth length (2" for unit E, 1½" for unit B - the section in the corner doesn't require plinth or architrave, 3" for unit A, plus three times 3" for the exposed sides. This adds up to 15 ½" so it is rounded up to 18"). In addition, one exposed end panel will be required. The two exposed sides enclosing the bed area can also be panelled if you wish, but this is not necessary. If you do wish to panel them, you will need to order two extra side panels.

The room on the right is 11½" wide. The units used in the centre room wouldn't allow any space for fitting, so the corner unit has been placed on the left hand wall (B), which gives us 1/8" for fitting (as we can take advantage of the flexibility of the corner unit, constructing it to the 1 7/8" standard depth) There is then a single 1½" wardrobe (C), the two double spanning units (D and E), and the single 2" wardrobe (F). The left hand wall section has been completed with a second 1½" wardrobe. The small gap remaining to the right of the main run of units can be filled with a filler panel. This room would require one 18" strip of plinth and one 18" strip of architrave, as explained above.

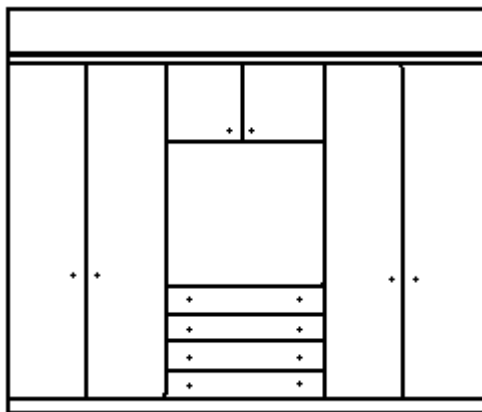

It is of course possible to create a simple run of wardrobes without spanning units, or the space for a bed. Alternatively you might like to put one spanning unit in the centre of a run of wardrobes, with a chest below, thus creating a "vanity" area (see left). In this example, if the room were just over 9" wide, you could order a filler strip for either side, and one section of plinth 12" long (the nearest multiple of 6") and one section of architrave 12" long. If on the other hand, the units were to form a block along one side wall, with an exposed end towards the opening of the house, then you would still need to order a 12" section of architrave, and one of plinth (length of the units, 9", plus 3" for the

exposed end. You would also order one exposed end panel, according to the style of your units.

All wardrobes are supplied with two interior shelves (one at the top and one at the bottom – for shoes etc) and a hanging rail with supports.

Units can be combined in a variety of ways to create very different looks. The photographs at the front of the catalogue show for instance how effective two 3" Modern Classic chests look when they are combined into a single unit. The same room features a panel behind the bed with a shelf along the top, and two optional small bedside shelves.

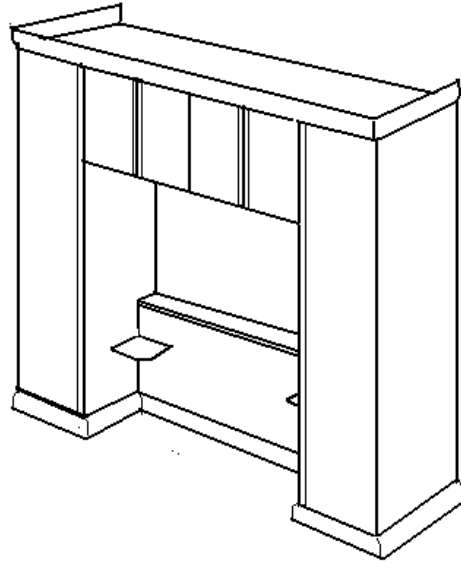

This panel can be used with any of the styles. Classic models are supplied with mouldings to enhance the shelf edge and co-ordinate it with the units. All models are supplied with the two small bedside shelves, which you may use as shown, or leave out if you prefer.

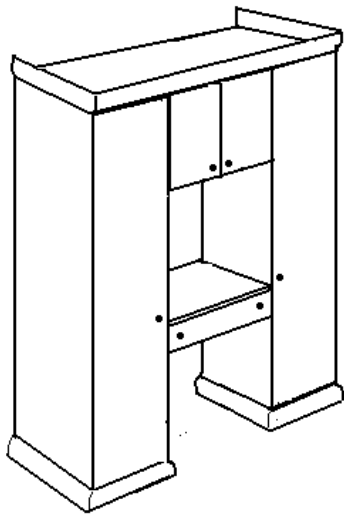

There is a single vanity shelf unit in the range that can be used between wardrobes, either together with a spanning cupboard, as shown below left, or on its own.

Drawer units may also be used as freestanding units. Panels are available in different styles to complete the units, however, remember that with panelling and plinth, a 1½ " unit will have a finished width of 1 7/8" and a 2" chest a total finished width of 2 3/8".

These units may be used as bedside cabinets should you wish. Where space may be limited, it is possible to join a drawer unit to a corner unit as shown, creating a bedside unit that can be used to show off a lamp or other miniatures.

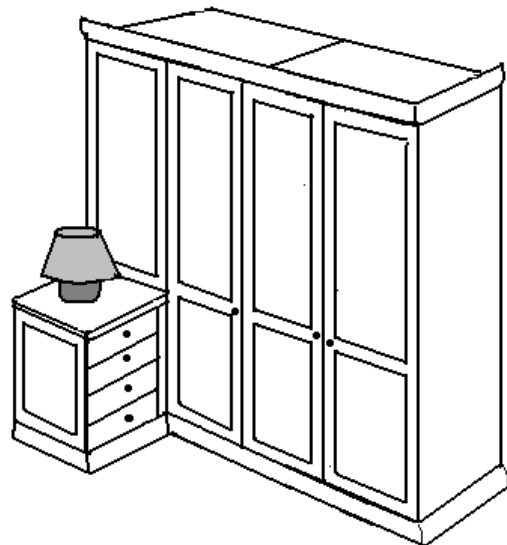

Door styles

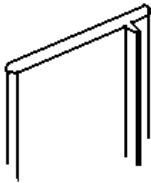
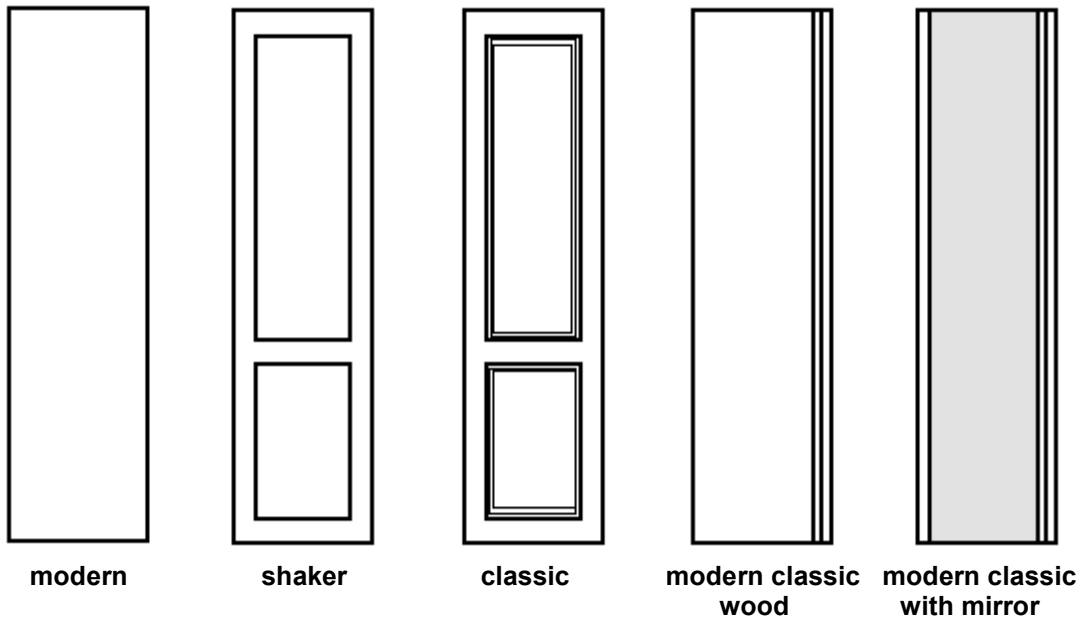

Detail showing integral handle of the modern classic door.

Mirrors are available for the combination unit in Shaker and Classic styles.

Handles

Knobs – available in wood (these may be painted if desired), brass (these may be painted to give an aluminium or chrome effect) or crystal (these have gold-plated mounting, and cannot be painted.)

“D” shaped handles in aluminium - small (1/2” appx), medium (1” appx) or large (1½”)

You may of course purchase other suitable handles from any supplier of miniature hardware. Venetian glass stud earrings can make novel handles, as can small silver stud earrings that come in a variety of fun shapes and designs.

ELF Bedroom Kits Units and accessories

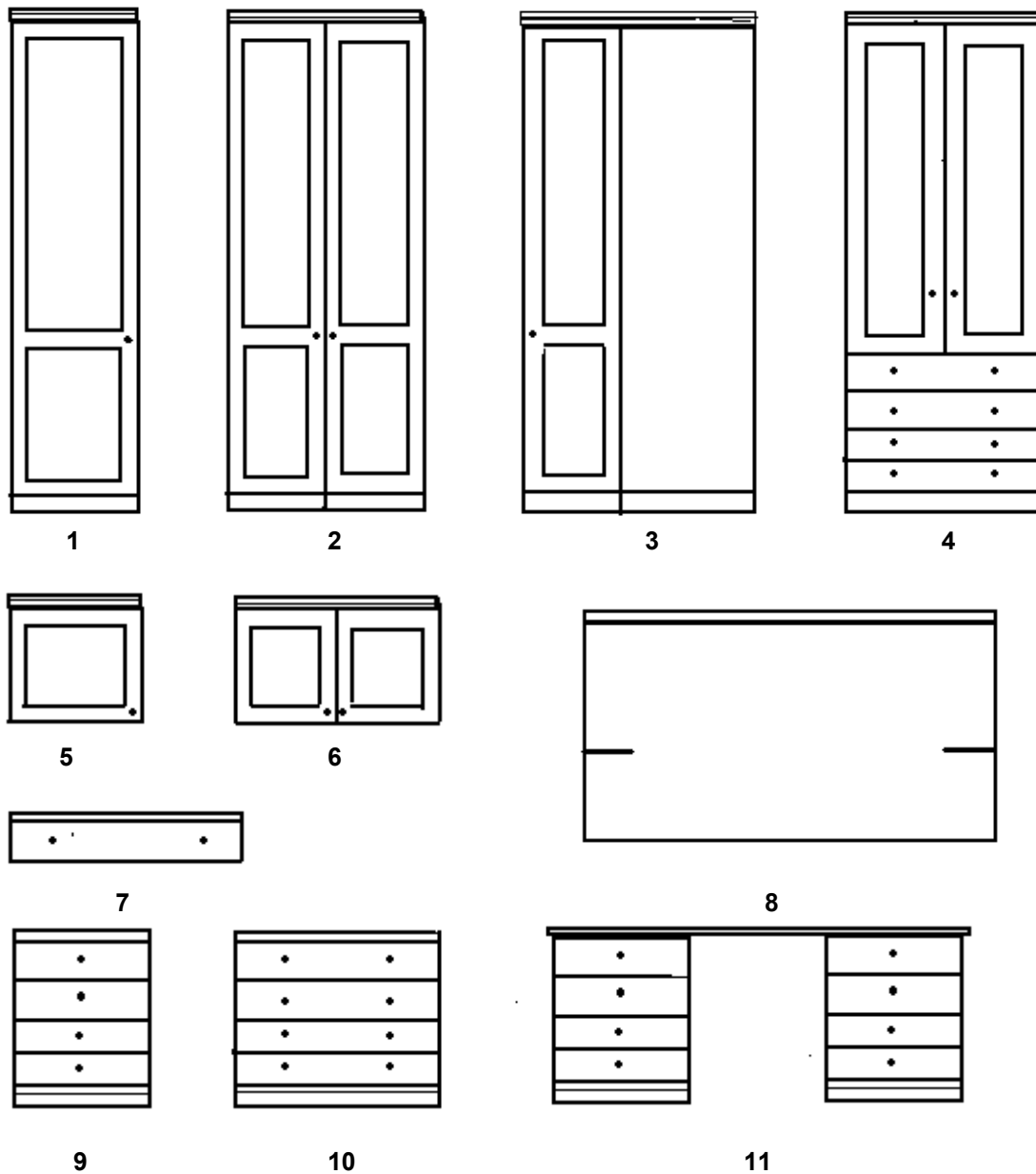

Unit 7 is a single drawer 3" wide, designed to fit between two wardrobes to create a vanity unit. It can be combined with a double spanning unit (6) above, linking the two wardrobes for a fully fitted look.

Unit 8 is a panel with a shelf along the top, and with optional bedside shelves, designed to fit between wardrobes where 2 x 3" spanning units may be used above.

Unit 11 comes as a complete kit, comprising two drawer units, and one continuous top, with panelling and plinth to complete all exposed sides.

Units 9 and 10 can be combined with wardrobes, or finished on all sides, and used as freestanding chests of drawers.

Mirrors are available for the combination unit doors in shaker and classic styles. Please note that plain drawers are supplied with shaker wardrobes, and wooden modern classic drawers with mirrored modern classic wardrobes.

ELF Fitted Bedrooms – Price list

| Code | Description | Widths | Unit price Modern classic(wood)/ Shaker | Unit price Classic | Modern classic with mirrors | Unit price Modern |
|------|--------------------------------------|--------------|--|--------------------------|--------------------------------------|-------------------------|
| 1 | Single wardrobe | 1½", 2" | 9 | 11 | 13 | 9 |
| 2 | Double wardrobe | 3", 3 ½", 4" | 11 | 14 | 19 | 11 |
| 3 | Corner wardrobe | 3½", 4" | 11 | 13 | 15 | 11 |
| 4 | Combination wardrobe | Single 2" | 22 | 26 | N/A | 22 |
| | | Double 3" | 26 | 32 | N/A | 26 |
| 5 | Single spanning unit | 1½", 2" | 7 | 8 | N/A | 7 |
| 6 | Double spanning unit | 3" | 9 | 10 | N/A | 9 |
| 7 | Single drawer unit | 3" | 5 | 6 | N/A | 5 |
| 8 | Back panel | 6" w x 3" h | 5 | 6 | N/A | 5 |
| 9 | Single chest | 1½", 2" | 18 | 20 | N/A | 18 |
| 10 | Wide chest * | 3" | 20 | 22 | N/A | 20 |
| 11 | Dressing table combination | 5¼" | 36 | 40 | N/A | 36 |
| 12 | Platform bed (see photo front cover) | 6¼" x 4¼" | £7 | | | |

Finishing packs.

| Code | Description | Length if applicable | Unit price |
|------|---|---------------------------------------|--------------|
| SP | Shaker side panelling tall unit | | 1.00 |
| CP | Classic side panelling tall unit | | 2.00 |
| PP | Plain side panelling tall unit | | 1.00 |
| PPCH | Plain side panel chest | | 0.50 |
| SPCH | Shaker side panel chest | | 0.50 |
| CPCH | Classic side panel chest | | 1.25 |
| AS | Architrave simple (modern, modern classic, shaker) | Up to 18" | 0.50 per 6" |
| AC | Architrave classic | Up to 18" | 0.50 per 6" |
| PS | Plinth simple (modern, modern classic shaker) | Up to 18" | 0.75 per 6" |
| PC | Plinth classic | Up to 18" | 0.75 per 6" |
| M | Mirrored doors for combination units, Shaker or classic | 2" unit (1 door) 3" unit (2 doors) | 4.00 8.00 |
| F | Filler strip and support | | 0.75 |
| | Quick clamps (one supplied FREE with every order) | Additional | 75p Each |

* If you wish to combine two (or more) wide chests to create a single unit, please note this on the order form, and you will receive x one single long top to cover all the units.

To calculate how much architrave or plinth you require, add up the total length of the units in any one run, and add 3" for each exposed end. This will allow for mitring. (Both plinth and architrave packs include wood to make supports for these and the wardrobes).

Please note. All mirrors are real glass mirrors, NOT plastic substitutes.

All prices are in £ sterling. For other currencies, use www.xe.com/acc for conversions.

ELF Bedroom Kits[©]

The ELF Bedroom Instruction Manual CD, available with the kits, is a comprehensive guide to building your bedroom using ELF Bedroom Kits[©]. With clear diagrams it explains stage by stage how to create a bedroom of which you can be proud.

There are full descriptions of all the finishes that you can use for the doors, and easy-to-follow instructions for achieving first-class results. There are suggestions about which paints are the most suitable, and hints on using unusual materials to achieve unique results.

You do not need expensive tools, or any prior knowledge of woodworking. In addition, we give you lots of hints on using easily available items to aid you in your work, such as the use of rubber bands instead of clamps, or Lego[®] bricks to create a support for your units while you build them. (And with every order - **we give you a quick clamp** to hold the doors together firmly while the glue dries - and you get on with the next one!)

We give you a small pack of wood off-cuts, so that if there is anything you are unsure about, you can have a practice run first without risk of spoiling your kit. .

You can purchase in one go all the kits to make a whole bedroom, or buy the pieces one at a time, making up the units as you go, and watch your bedroom take form as you add to it (if you choose to do this, we strongly recommend that you plan the whole bedroom first, even if you buy the units at intervals). When you have made up all the individual units in a particular block, you can then add the continuous plinths and architraves to complete your bedroom.

With ELF Bedroom Kits[©] you don't have to limit yourself to one standard style of bedroom. You can have the bedroom YOU want, in the style and finish YOU want, thus creating a truly unique room.

ELF Kits[©] bring a new way of thinking to the world of miniatures, giving you the opportunity to create furniture for the present that will last into the future.

ELF Kitchen Kits[©]

101 Glenville Grove, London SE8 4BJ, London SE8 4BJ. Tel ++ 44 (0)20 8694 0536
www.elfminiatures.co.uk email elizabeth@elfminiatures.co.uk

ELF Fitted Bedroom Kits[®] Main Order Form

Please use this section of the form if you wish to make any notes about your order – such as additional units you wish to order but couldn't fit on the form, or any queries or special requirements you may have discussed with us (e.g. continuous top for multiple chests).

Please state whether you would like hanging rail in brass or aluminium:

NAME: TEL.....
(queries only)

ADDRESS:

..... EMAIL.....
(queries only)

.....

POSTCODE / ZIPCODE

COUNTRY

PAYMENT BY CREDIT CARD

VISA / MASTERCARD (Delete as necessary)

NAME ON CARD:

CARD NO: _____

CARD SECURITY NUMBER (Last 3 digits on reverse of card): _____

EXPIRY DATE _____(MTH) / _____(YEAR)

CARDHOLDER SIGNATURE:

PAYMENT BY CHEQUE (UK BANK ONLY) Cheques should be made payable to ELF.

POST & PACKING UK £2.00
OVERSEAS - charged at cost (please contact us for further details)

ELF Kitchen Kits[®]
101 Glenville Grove, London SE8 4BJ, London SE8 4BJ. Tel ++ 44 (0)20 8694 0536
www.elfminiatures.co.uk email elizabeth@elfminiatures.co.uk